

RRK 180 Ex / RRK 200 Ex / RRK 250 Ex



For the delivery of small volume flows for the ventilation of rooms and workspaces in commercial and industrial buildings where the occasional occurrence of potentially explosive atmospheres can be expected. Suitable for installation in the pipeline.

Approved for operation in zones 1 and 2 according to DIN EN 60079-10. Especially suitable for the ventilation of chemical and pharmaceutical laboratories, storerooms, workshops, dyeing facilities, battery rooms, etc.

■ **Special features**

- ☐ EC type-examination certificate provided according to Directive 2014/34/EU (ATEX).
- ☐ Explosion protection, increased safety according to DIN EN 60079-0, 60079-7, 1127-1, 14986.
- ☐ Operating voltage Alternating current ~230 V, 50 Hz.
- ☐ Preferably for direct installation in the pipeline. Cross-section reduction possible. See diagram RRK 180 Ex for perform. loss.
- ☐ Low space requirement and minimal installation costs due to linear throughflow.
- ☐ Installation poss. in any position.

Description

■ **Casing and impeller**

Made of high-quality, break-re-

sistant and antistatic plastic. Surface resistance lower than $10^9 \Omega$.

■ **Motor**

Closed design (IP54) for continuous operation. Ball bearing mounted, with moisture protection, maintenance-free and radio interference-free.

■ **Electrical connection**

Terminal box made of plastic, IP54, explosion-tested, on outside of duct casing.

■ **Installation**

In any position. For supply and extract ventilation through corresponding installation.

■ **Installation information**

The regulations DIN EN 60079-10 shall apply. According to this, overload protection must be provided for each fan by a motor protection circuit breaker, which must be triggered within the heating time specified in the test certificate in case of a short circuit.

Fans must be protected by a protection grille or shutter against foreign bodies larger than 12 mm getting sucked in or falling in.

Approved operating mode according to DIN EN 60034-1/VDE 0530 = S1 (continuous operation). Speed control is not permitted.

Dimensions RRK 180 Ex / RRK 200 Ex / RRK 250 Ex

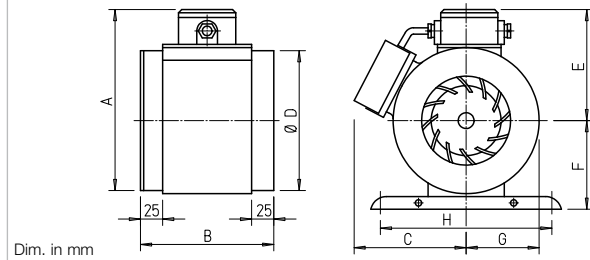

Type	RRK 180 Ex	RRK 200 Ex	RRK 250 Ex
A	231	278	304
B	164	267	205
C	160	195	210
D	Ø 178	Ø 198 ¹⁾	Ø 248
E	142	179	180
F	120	140	160
G	92	115	128
H	275	299	311

¹⁾ via reducers connected on the inlet and outlet side.

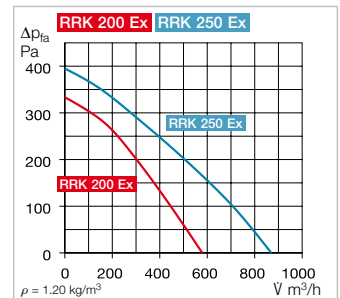
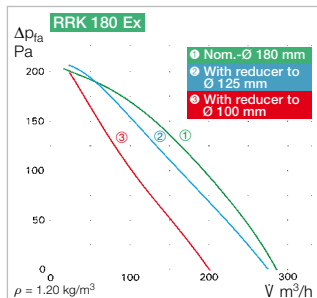

■ **Accessories for RRK 180 Ex Reducer**

RZ 180/125	Ref. no. 05876
RZ 180/100	Ref. no. 05877

■ **Accessories for all types Mounting bracket**

MK 4	Ref. no. 05824
------	----------------

Flexible connecting sleeve

For installation between fan and duct system.

FM 180 Ex	Ref. no. 01685
FM 200 Ex	Ref. no. 01686
FM 250 Ex	Ref. no. 01688

Protection grille

SGR 180 Ex	Ref. no. 05051
SGR 200 Ex	Ref. no. 05049
SGR 250 Ex	Ref. no. 05052

Duct shutter

RSK 180	Ref. no. 05662
RSK 200	Ref. no. 05074
RSK 250	Ref. no. 05673



■ **Other accessories Page**

Filters and silencers	481 ff.
Flexible ventilation ducts, ventilation grilles, fittings and roof outlets	561 ff.
Disc valves	582 ff.

■ **Reference Page**

Explosion protection	
– Zoning	18
– Directive 2014/34/EU	20

Type	Ref. no.	Impeller Ø	Flow rate free blowing	Rated speed	Sound power L _{WA}	Sound press. at 1 m	Power consum.	Current consum.	Wiring diagram	Max. air flow temp.	Weight net approx.
		mm	m³/h	min⁻¹	dB (A)	dB (A)	W	A	No.	+°C	kg
Explosion-proof, II 2G Ex eb h IIB + H₂ T3 Gb, Alternating current 230 V, 50 Hz, Protection category IP54											
RRK 180 Ex ¹⁾	05889	170	290	2780	66	58	50	0.25	453	50	3.0
RRK 200 Ex	05890	215	560	2860	64	56	200	0.92	453	50	5.5
RRK 250 Ex	05891	240	870	2860	77	69	300	1.40	453	50	7.0

¹⁾ Temperature class T4.